

# Cangxian Huahai

SHIJIA VILLAGE CANGZHOU CITY HEBEI PROVIN



Specification:

# STEEL PIPE NIPPLES

- The material for Seamless steel pipe conforms
- Seamless Steel Nipple Design/Dimensions con
- Contact HUAHAI for exact dimensional informat
- NPT threads on Nipples conform to ASME B1.2
- The ends of the Nipple are chamfered on the o
- to the central axis and free from burrs
- Ends are cut square to the central axis.
- All nipples are stamped with heat code and ma

## OUTSIDE DIA. TOLERANCES

PIPE SIZE	TOL.
1/8"-1 1/2"	+/- 1/64
2"-8"	+/- 1% OF NOM.

Nipples over 12" long have a length tolerance of +/- 1/8"

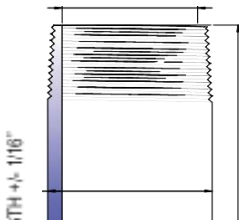

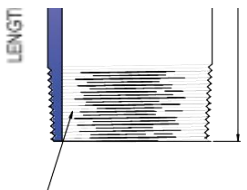

Standard NPT (Tapered)  
ANSI B 1.20.2 Specification



Cangxian Huahai

SHIJIA VILLAGE CANGZHOU CITY HEBEI PROVINCE

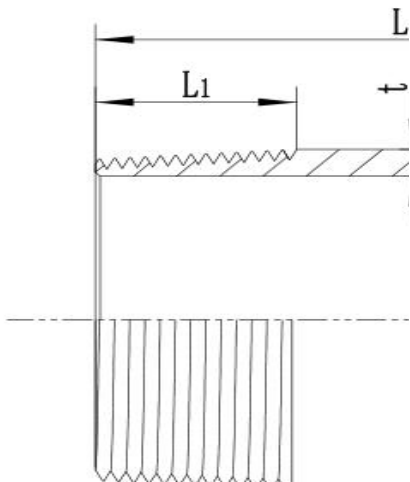



Pipe Size	Close Lgth	Close	1-1/2"	2"	2-1/2"	3"	3-1/2"
1/8"	3/4"	26.45	28.10	30.09	32.91	36.26	39.89
1/4"	7/8"	31.19	31.94	35.22	38.24	42.85	47.31
3/8"	1"	33.67	35.06	38.24	43.00	48.47	53.29
1/2"	1-1/8"	17.49	18.67	20.52	22.67	24.97	28.54
3/4"	1-3/8"	19.76	21.22	22.16	25.08	27.98	31.78
1"	1-1/2"	27.98		29.58	31.84	37.17	41.27
1-1/4"	1-5/8"	35.11		36.53	40.23	46.73	51.08
1-1/2"	1-3/4"	43.00		44.72	48.70	55.98	61.08
2"	2"	42.14			47.43	55.12	59.33
2-1/2"	2-1/2"	140.31				147.24	158.35
3"	2-5/8"	177.05				187.25	200.12
4"	2-7/8"	252.42					
5"	3"	409.15					
6"	3-1/8"	459.62					



# i Pipe Fittings CO., Ltd

ICE CHINA Tel:+8618331781951 [www.sspipenipple.com](http://www.sspipenipple.com)



Sch. 80 / XH

XXH



to the requirements of ASTM A106 Grade B.  
form to ASTM A733.

ion.

20.1. Threads are right hand on both the ends.  
outside at an angle of  $35^{\circ} \pm 10^{\circ}$ .

terial sepcifications

ed Pipe Threads) as per  
fication

[pipenipple@163.com](mailto:pipenipple@163.com)  
[info@sspipenipple.com](mailto:info@sspipenipple.com)

SS Pipe Fittings CO., Ltd

ICE CHINA Tel:+8618331781951 [www.sspipenipple.com](http://www.sspipenipple.com)

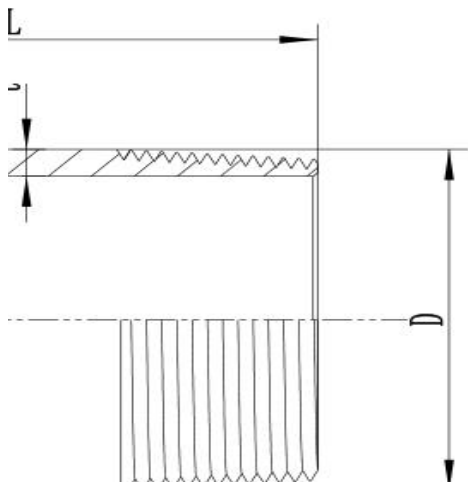





4"	5"	6"	7"	8"	9"	10"	11"
44.22	65.97	75.59	82.19	86.66	92.35	98.19	103.94
52.47	80.77	91.38	98.38	103.94	109.62	115.49	121.25
57.87	85.28	96.65	103.94	111.38	118.37	125.62	132.83
31.16	39.48	46.38	62.43	67.44	72.51	77.56	82.58
34.89	43.52	50.20	67.44	73.34	79.25	85.06	91.13
46.14	57.95	66.23	91.78	100.25	107.01	114.94	124.29
57.13	72.02	82.80	115.27	126.00	136.31	147.46	157.67
68.37	86.42	101.68	135.46	147.45	159.55	171.35	183.30
66.28	83.71	95.53	138.28	150.80	163.31	175.67	188.12
164.24	184.89	202.63	222.65	242.37	262.26	281.98	300.52
211.86	239.18	262.87	299.91	323.98	348.78	375.91	398.80
285.62	327.91	357.22	399.44	435.22	470.62	505.27	542.48
	513.24	563.19	622.86	670.51	731.20	769.17	839.09
	579.35	642.03	714.61	773.71	849.40	896.82	983.75

[pipe nipple@16](mailto:pipe nipple@16)  
[info@sspipe nipple](mailto:info@sspipe nipple)

[.com](#)





i3.com

le.com

.com

<b>12"</b>
109.62
127.01
140.06
87.70
96.86
132.01
170.58
195.32
209.87
320.33
422.88
576.22
896.09
1054.75

[i3.com](#)

[le.com](#)